

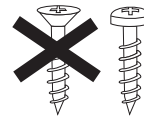

# Jalousie 25/35 mm

Typ 8800

Bitte nur beiliegende Schrauben verwenden.  
Please use enclosed screws only.  
Se servir exclusivement des vis jointes.  
Просьба использовать только приложенные винты.



Wichtig! Bitte aufbewahren.  
Important! Please keep together.  
Important! Veuillez conserver.  
Важное указание!  
Просьба хранить!

**Achtung: Jalousie muss waagrecht montiert werden.**

Montage • Fitting • Montage • Монтаж

**Beachten**  
für Clipmontage

<b>105°</b> 	<b>entfernen</b> <b>102°</b> 	<b>102°</b> 	<b>100°</b> 
<b>96°</b> 	<b>90°</b> 	<b>entfernen</b> 	

**Clip-  
montage**  
genormte,  
ungenormte  
Dachfenster

**Bitte beachten**  
100 mm  
je Seite

**genau anlegen**

**Achtung:**

- 
- min. 45 mm**
- Ø 2 mm**
- 
- 
- 
- 
- 
- 2x**
- 
- 
-



# Jalousie 25/35 mm

Typ 8800

Bitte nur beiliegende Schrauben verwenden.  
Please use enclosed screws only.  
Se servir exclusivement des vis jointes.  
Просьба использовать только  
приложенные винты.

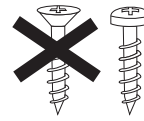

Wichtig! Bitte aufbewahren.  
Important! Please keep together.  
Important! Veuillez conserver.  
Важное указание!  
Просьба хранить!

**Achtung: Jalousie muss waagrecht montiert werden.**

Montage • Fitting • Montage • Монтаж

## Montage mit Seitenträgern

Pick'n Click für Velux Fenster

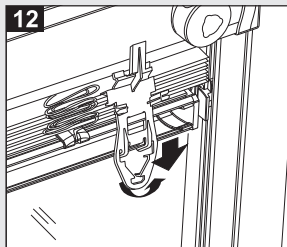
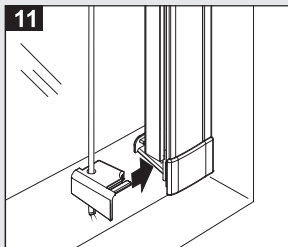
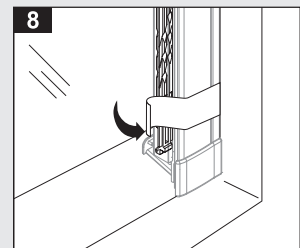
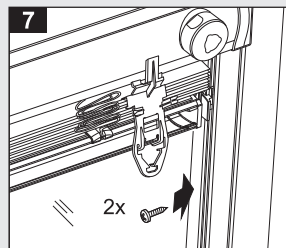
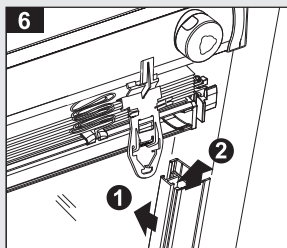
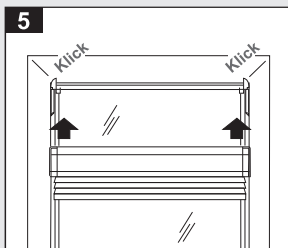
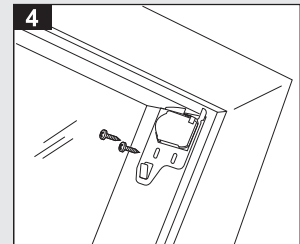
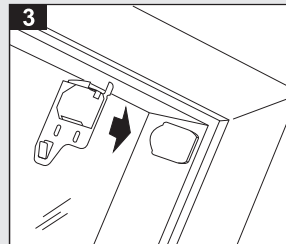
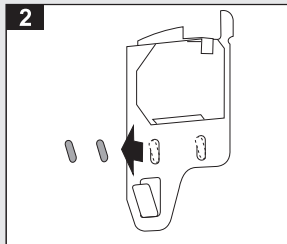
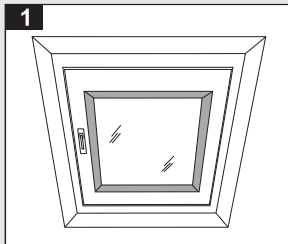
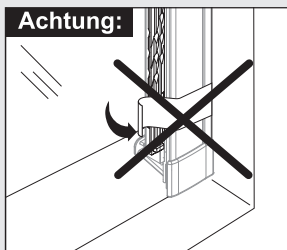
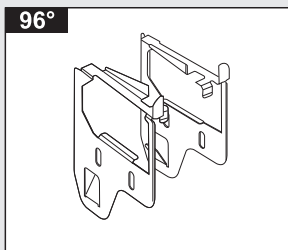

Demontage • Disassembly • Démontage • Демонтаж

